

NATIONAL BLVD. & OVERLAND AVE.

LOS ANGELES, CA (SE CORNER)



BRAND NEW CONSTRUCTION!

- EXCELLENT VISIBILITY FROM I-10
- SIGNALIZED INTERSECTION
- 19 PARKING SPACES
- OVER 100,000 +/- CARS DAILY!
- DENSELY POPULATED AREA



POPULATION		
<u>1-Mile</u>	<u>3-Mile</u>	<u>5-Mile</u>
45,933	320,126	456,947

HH INCOME		
<u>1-Mile</u>	<u>3-Mile</u>	<u>5-Mile</u>
\$80,229	\$93,707	\$99,557

LEVY
AFFILIATED HOLDINGS, LLC.

FOR MORE INFORMATION,
PLEASE CONTACT
JONATHAN KOHN
310.451.5569

NATIONAL BLVD. & OVERLAND AVE.

LOS ANGELES, CA (SE CORNER)

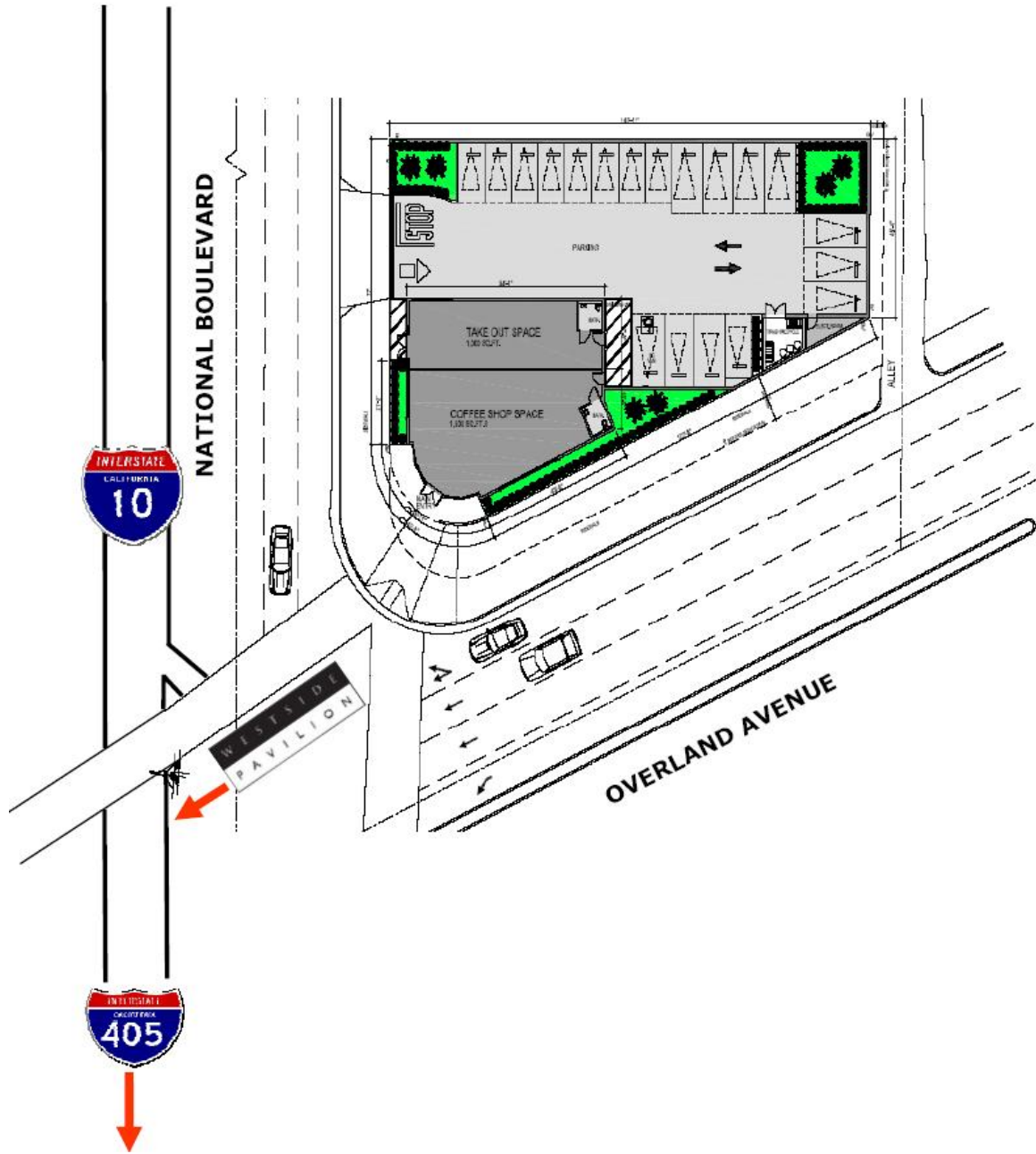

LEVY
AFFILIATED HOLDINGS, LLC.

FOR MORE INFORMATION,
PLEASE CONTACT
JONATHAN KOHN
310.451.5569